

FOR SUB-LEASE

5520 Nobel Drive, Suite 100
Fitchburg, WI 53711



PLATYPUS

TECHNOLOGIES



Subleasing Information

Platypus Technologies has secured a long-term lease on the property, and we seek to sub-lease a portion of the available laboratory and office space.

Space Available for Sub-lease:

- Laboratory: 1,100 sq. ft.
- Open office space: 515 sq.ft.
- Private offices: 125 sq. ft. (x3)

Date Available: Immediate

Sub-lease Terms: 12-month minimum

Modified Gross Rent: \$25.00 per sq. ft.

Other: Electric, suite cleaning, HVAC: \$1,150 per month

Property Profile

- Located in Fitchburg Technology Campus
- Front-door parking
- Loading dock
- 45-person conference room
- Breakroom with Vending
- Fitness Center
- Restrooms equipped with showers
- On-site dry-cleaning pick-up/drop-off
- Outdoor patios
- Restaurants and coffee shop nearby
- Bike path access

For more information, please contact:

Marco Bedolla

Office: 608-237-1270

Email: mbedolla@platypustech.com

FOR SUB-LEASE

5520 Nobel Drive, Suite 100
Fitchburg, WI 53711



PLATYPUS

TECHNOLOGIES

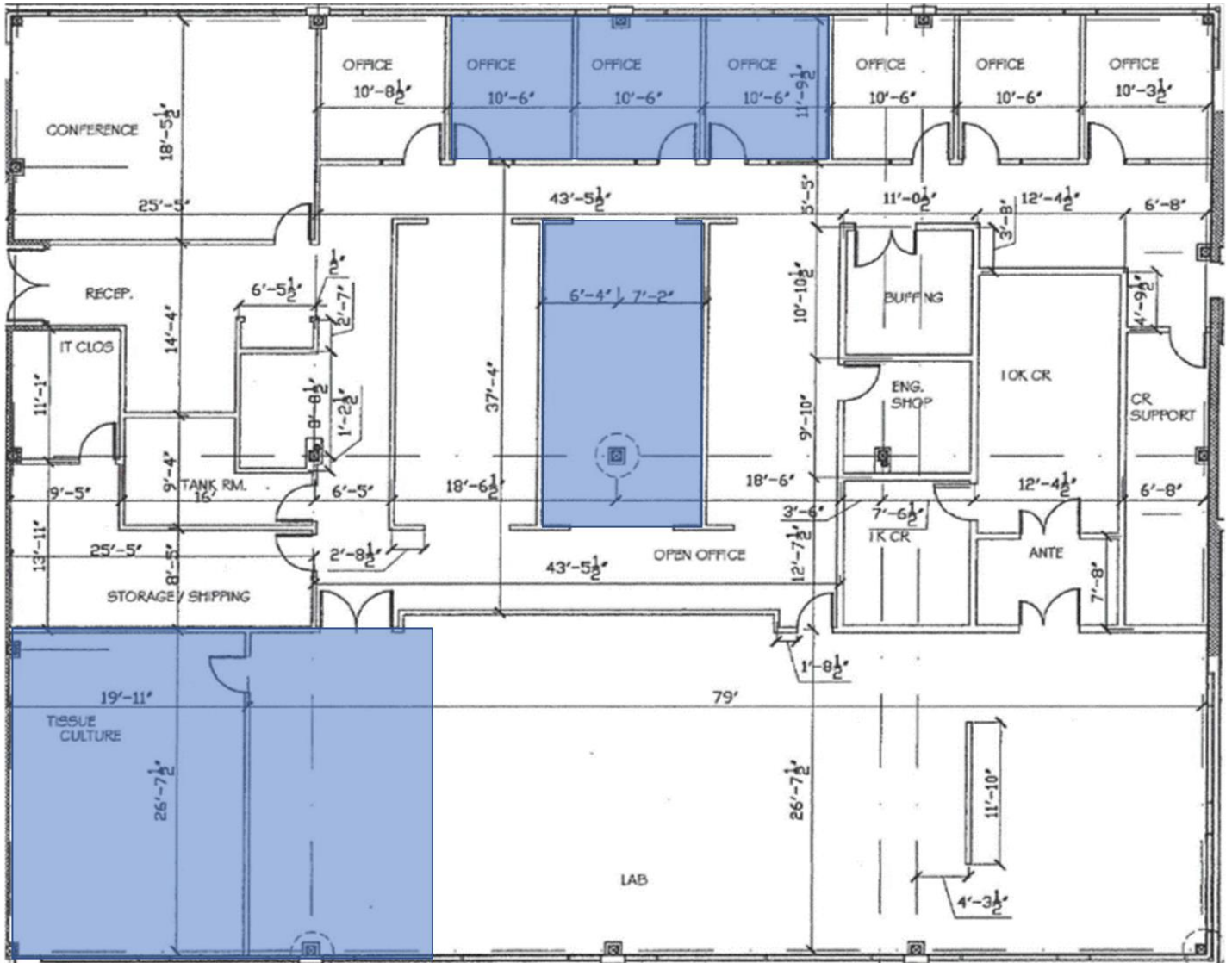

Shaded Blue area represents area available for sub-lease

For more information, please contact:

Marco Bedolla

Office: 608-237-1270

Email: mbedolla@platypustech.com

FOR SUB-LEASE

5520 Nobel Drive, Suite 100
Fitchburg, WI 53711



PLATYPUS

TECHNOLOGIES

Laboratory Features

Fully equipped cell culture laboratory
Zeiss AxioPhot Fluorescent Microscope
Plate Reader
Multiple cell incubators
Cell culture hoods
Eppendorf Centrifuge
Refrigerator and freezer
Barnstead purified water system
Dedicated gas tank room
Chemical fumehood

Additional Features

High-speed wireless internet
Dedicated IT server room
Furnished Private offices
Kitchenette
Conference Room
File cabinets
Storage for laboratory supplies
Shared building facilities

- Gym
- Autoclave
- Dishwasher
- Icemaker



For more information, please contact:

Marco Bedolla

Office: 608-237-1270

Email: mbedolla@platypustech.com

FOR SUB-LEASE

5520 Nobel Drive, Suite 100
Fitchburg, WI 53711



PLATYPUS

TECHNOLOGIES

